

## LANCIA SCHIUMA AUTOASPIRANTE Mod. FI – CSA SELF-EDUCING FOAM BRANCHPIPE Mod. FI – CSA

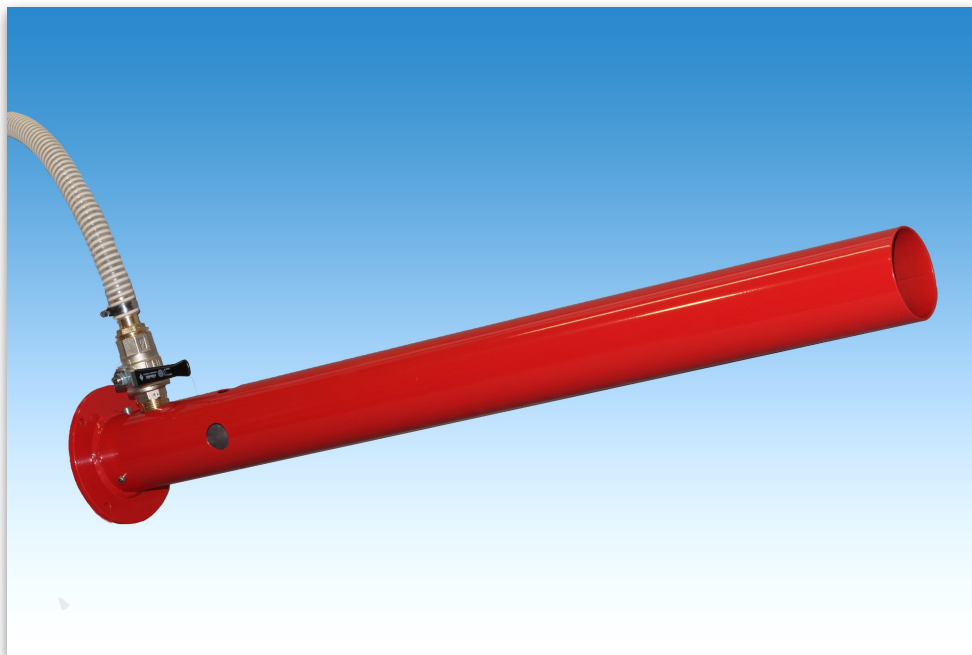

### CARATTERISTICHE:

- Corpo: in acciaio inox
- Attacco: flangiato
- Ugello: alluminio
- Aspirazione schiumogeno: 3% o 6%

### SU RICHIESTA:

- Valvola selettiva 0-3%-6%

### CHARACTERISTICS:

- Body: stainless steel
- Connection: flanged
- Nozzle: light alloy
- Foam mixing: 3% or 6%

### ON REQUEST

- Selectable mixing valve 0-3%-6%

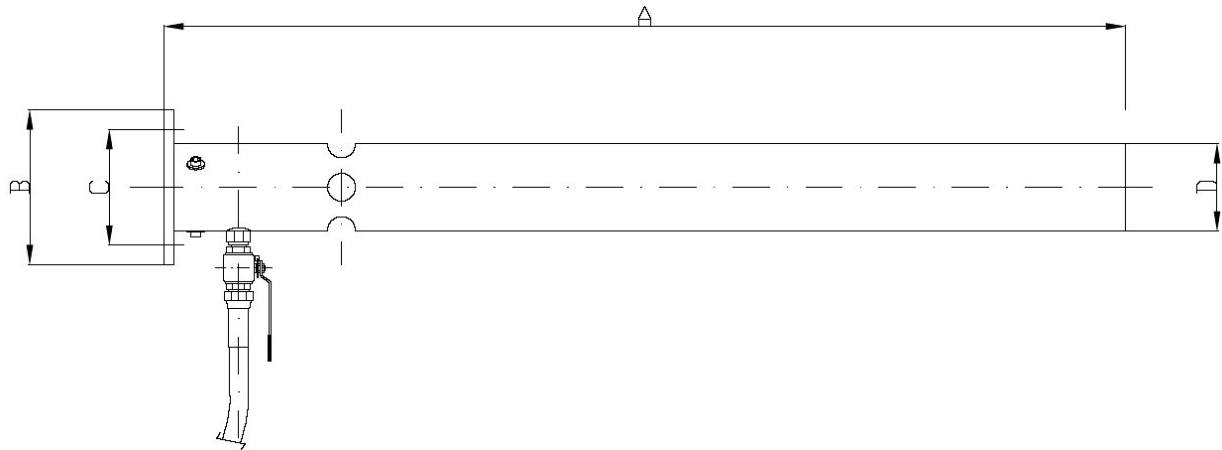

MODELLO MODEL	PESO / WEIGHT Kg	A	B	C	D	PORTATA/ CAPACITY LTS/1' A 7 BAR
<b>FI-CSA 5</b>	5,0	900	160	140	3"	500
<b>FI-CSA 10</b>	5,0	900	160	140	3"	1.000
<b>FI-CSA 15</b>	5,0	900	160	140	3"	1.500
<b>FI-CSA 20</b>	5,0	1.000	160	140	3"	2.000
<b>FI-CSA 25</b>	5,0	1.000	160	140	3"	2.500
<b>FI-CSA 30</b>	6,0	1.000	160	140	4"	3.000
<b>FI-CSA 40</b>	6,0	1.000	160	140	4"	4.000
<b>FI-CSA 50</b>	12	1.100	240	210	5"	5.000
<b>FI-CSA 60</b>	12	1.100	240	210	5"	6.000
<b>FI-CSA 70</b>	12	1.100	240	210	5"	7.000
<b>FI-CSA 80</b>	12	1.100	240	210	5"	8.000
<b>FI-CSA 100</b>	12	1.100	240	210	5"	10.000

MODEL	PRESSURE IN BAR									
	5	6	7	8	9	10	11	12	13	14
	FLOW ( Lts./1' )									
<b>FI-CSA 5</b>	500	550	590	635	670	710	740	775	805	-
<b>FI-CSA 10</b>	800	900	1000	1100	1150	1200	1250	1300	1370	1420
<b>FI-CSA 15</b>	1100	1250	1500	1580	1630	1720	1830	1880	1910	1960
<b>FI-CSA 20</b>	1600	1680	2000	2010	2110	2200	2300	2350	2420	2500
<b>FI-CSA 25</b>	2000	2250	2500	2560	2620	2780	2810	2920	3000	3060
<b>FI-CSA 30</b>	2500	2650	3000	3120	3250	3500	3620	3800	3860	3920
<b>FI-CSA 35</b>	2950	3240	3500	3740	3960	4180	4380	4580	4770	4950
<b>FI-CSA 40</b>	3300	3600	4000	4150	4250	4460	4880	5000	5120	5300
<b>FI-CSA 45</b>	3800	4160	4500	4810	5100	5370	5640	5890	6130	6360
<b>FI-CSA 50</b>	4150	4360	5000	5350	5860	6000	6150	6300	6420	6560
<b>FI-CSA 60</b>	5070	5550	6000	6415	6800	7170	7520	7850	8170	8480
<b>FI-CSA 70</b>	5916	6480	7000	7483	7937	8366	8772	9162	9537	9897
<b>FI-CSA 80</b>	6762	7407	8000	8553	9072	9563	10029	10475	10903	11314
<b>FI-CSA 100</b>	8452	9259	10000	10692	11340	11953	12537	13094	13629	14143

### Throw Curves

